



Indemne Book

Confidential document, for internal use only



Summary

Products:

Gimme clear!	p.3
Antiseche nourishing oil.....	p.4
Miss Ella lotion.....	p.5
Eau de Genie.....	p.6
Gimme smooth!	p.7
Bubble-in	p.8
Gimme soothing! cleansing base.....	p.9
Gimme soothing! lotion.....	p.10
Gimme clean! shampoo.....	p.11
Gimme clean! lotion.....	p.12
Moussailon soap.....	p.13
Domi-no (blackhead remover).....	p.14
I love K (konjac sponge).....	p.15

Kits:

Anti-imperfection kit.....	p.16
Anti-cellulite kit.....	p.17
Anti-irritation kit.....	p.18
Anti-itching kit.....	p.19

General precautions for use.....	p.20
----------------------------------	------

GIMME CLEAR!

My field of action

- ✓ Regulates sebum excess
- ✓ Reduces imperfections (pimples, microcysts up to acne of teens and adults)
- ✓ Helps to heal pimples to regain a smooth skin texture

My essential oils

- 🍷 Cinnamon
- 🍋 Lemon
- 🥕 Carrot seeds
- 🌰 Hazelnut

My effects

- 🌿 Anti-infectious and astringent
- 🍋 Antiseptic and antibacterial
- 🥕 Regenerating and healing
- 🌰 Protective and healing

My use



- 1 Carefully clean the zone to be treated with Miss Ella lotion or the cleansing base Gimme soothing!.
- 2 Rinse with Eau de genie, a thermal water or a floral water (avoid the tap water wich is calcareous).
- 3 Apply few drops of Gimme clear! lotion on your face or on areas with blemishes and massage until complete penetration of the product.



My key tips

- Recommended from teenage years but children can use it on mosquito spots.
- Every night, or every morning and evening application.
- Can be used in addition to the usual care and / or in single care.
- It is recommended to follow the protocol on minimum 56 days.
- It is recommended to continue the protocol as a preventive measure and / or from the reappearance of the first symptoms.

Proven effectiveness * !

71% have less imperfections

82% have smoother skin

76% have less sebum

100% tolerance

94% have softer skin

94% have cleaner skin

Clinical tests performed under dermatological control for 8 weeks out on 21 people with oily skin and with a 36 years average age.

ANTISECHE

My field of action

- ✓ Enhances the skin to the everyday life and wraps of a delicate and satiny veil
- ✓ Fed, protected and appeased skin
- ✓ Repaired hair
- ✓ Nourishes hands and feet

My oils

- 🌿 Sweet almond vegetable oil
- 🌿 Wheat germ vegetable oil
- 🌿 Neroli essential oil
- 🌿 Roman chamomile essential oil

My effects

- 🌸 Ultra nourishing and soft for the skin
- 🌾 Repairing
- 🍊 Regenerating
- 🌼 Anti-inflammatory



My use



- 1 Carefully clean the face and body with the cleansing base Gimme soothing! and gently dry.
- 2 Rinse the face with Eau de Genie, a thermal water or a floral water.
- 3 Apply few drops of Antiseche on the face, the body and the hair in order to find again a nourished, soothed and softened skin.

My key tips

Body:

After the shower, apply Antiseche in massage, it nourishes and reduces the visible aspect of stretch marks.

Face:

ANTISECHE easily replaces the day or night cream for a smooth and glowing skin throughout the day.

Hair:

Ideal in mask before shampoo, in repairing care and even after the sun, the hair regains their brilliance and their suppleness.

Feet:

ANTISECHE repairs and nourishes the driest zones for an immediate well-being.

It is recommended to follow the protocol until the improvement of the skin aspect.

Bottle duration of use: From 1 to 3 months on average, depending on the area to be treated.

Proven effectiveness* !



Tests and results in 21 days on chest.

MISS ELLA LOTION

My field of action

- ✓ Deep cleans while purifying, moisturizing, and soothing skin, even the most sensitives
- ✓ Removes face and eyes make-up (even the waterproof)
- ✓ Decongests

My ingredients

- 💧 Organic Roman chamomile floral water
- 🍋 Lavandin Grosso essential oil
- 🍋 Lemon essential oil
- 🍋 New Caledonia Sandalwood essential oil







My use



- 1 Soak a few drops of the micellar lotion on the konjac sponge or on a disposable or reusable cotton.
- 2 Gently pass over the eyes, face, neck and neckline. Repeat until cotton is clean.
- 3 Rinse the face carefully with Eau de genie, a thermal water or a floral water.
- 4 Apply Gimme clear! in case of acne-prone skin, or Antiseche for dry and uncomfortable skin.

My effects

-  Soothing, rebalancing
-  Anti-inflammatory, antibacterial, bactericidal, antifungal, calming and regenerating
-  Purifying and lightening
-  Calming, healing

My key tips

- For a softer skin, use the lotion with the I love K sponge the morning and evening.
- For the face: the Miss Ella lotion can be used in case of blemishes and acne scars because the lemon lightening action will blur them.
- For face and body: the chicken pox can be gently disinfected (from 3 years).

Duration of use: between 30 and 40 days depending on the area to be treated.

PATENTED

EAU DE GENIE



My field of action

- ✓ Alcohol-free tonic for all skin types
- ✓ Tightens pores, perfect cleansing and makeup removal
- ✓ Removes impurities
- ✓ Soft and enhanced skin
- ✓ Illuminates the complexion

My 100% pure and organic fruit waters

- 💧 Organic Lemon
- 💧 Organic Grapefruit
- 💧 Organic Apricot
- 💧 Organic Tomato

My effects

-  Purifying, decongestant
-  Astringent, invigorating
-  Moisturizing and protective
-  Regenerating, illuminating, antioxidant



My use



- 1 Gently clean the face with Miss Ella lotion or the cleansing base Gimme soothing!.
- 2 Spray at 15-20 cm from the face with your eyes closed, in order to perfect skin cleansing.
- 3 Finalize by wiping with cotton. Do not rinse.
- 4 If necessary apply a daily care or few drops of Gimme soothing!, Gimme clear!, Antiseche or Gimme clean! lotion.

My key tips

- Product that can be daily used and integrated into the care routine
- Ideal to fix the make-up
- It refreshes during the day, after the sport, in the subway, on the beach ...

Eau de Genie is suitable for all skin types

GIMME SMOOTH!

My field of action

- ✓ Slimming, circulatory, moisturizing and natural lotion that reduces all three types of cellulite (adipose, aqueous, fibrous)
- ✓ Reduces the orange-peel skin appearance
- ✓ Soft and smooth skin

My use



- 1 Apply few drops of Gimme smooth! lotion on a clean skin (hips, abdomen, thighs, legs, bottom, arms ...).
- 2 Manually massage the zones or reproduce the palper-rouler technique with one of the Bubble-in (lower body up to the heart) for 5 minutes on each zone.

My oils

- Eucalyptus Peppermint leaf oil
- Immortelle flower essential oil
- Grape seed vegetable oil
- Pink Grapefruit peel essential oil

My effects

- Draining, diuretic, fat-destroying
- Decongestant, anti-inflammatory, healing, favour circulation, softens fibrous areas
- Antioxidant, makes massage easier
- Improves the appearance of cellulite, strengthens, purifies lymph, eliminates toxins



My key tips

- For even more surprising results, use this anti cellulite oil in addition to the Bubble-in and / or Big Bubble-in.
- It is recommended to follow the protocol on minimum 8 consecutive weeks (= 2 bottles) and until the improvement of your skin appearance.
- It is recommended to continue the protocol as a preventive measure and / or as soon as the first symptoms reappear.

My precautions for use

- Recommended from the adolescence.
- Not suitable for pregnant women.
- Not recommended for varicose skin or a delicate venous system.
- It is recommended to use the product twice a day.

Clinical tests realized under dermatological control over a panel of 23 women for 56 days. Up to -3.4 cm of hip circumference, -2.9 cm of arm circumference, -1.9 cm of thigh circumference.

BUBBLE-IN

My field of action

- ✓ Fades orange-peel skin
- ✓ Toned, soft and smoother skin
- ✓ Favour blood circulation

My use



Massage 5 minutes per day on the relevant areas (arms, knees, calves)

My key tips

- With 5 minutes a day, it greatly reduces cellulite and dimples
- For best results use it in addition to the Gimme smooth! slimming lotion, or in the shower with the cleansing base Gimme soothing!

My precautions for use

- Do not use on varicose veins.
- Do not use on blessed or burned skin.
- Do not use on an allergic reaction, eczema or psoriasis skin.
- Do not use in case of cancer or lesions.
- Start with light aspirations as the skin gets used to the treatment. Gradually increasing the intensity is possible.
- If slight hematomas appear, slow down the use and make a lower aspiration.
- Products intended for adults, do not leave it to the sight of children, Bubble-in are not toys.

BIG BUBBLE-IN

My field of action

- ✓ Larger treated area
- ✓ Acts more in depth
- ✓ Fades orange-peel skin
- ✓ Toned, soft and smoother skin
- ✓ Favour blood circulation

My use

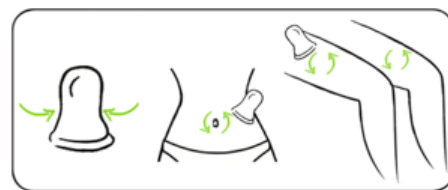

Massage 5 minutes per day on the affected areas (hips, bottom, abdomen, legs).

My key tips

- Can also be used for back massage or after a sport session to relieve and boost the blood circulation!
- Attack phase: 3 to 4 times per week minimum with 5 to 10 min per zone.
- Maintenance phase: 1 to 2 times per week with 20 min per zone.

- 1 Apply Gimme smooth! to facilitate the massage and increase results with its powerful active ingredients.
- 2 Evacuate the air from Big Bubble-in by pressing it and put it on the skin, a slight suction will "lift" the cellulite.
- 3 Vertically massage the skin from top to bottom, horizontally from left to right then with a zig-zag move doing a "Z".

GIMME SOOTHING!

CLEANSING BASE

My field of action

- ✓ Face and body gentle and natural cleansing gel
- ✓ Cleans, soothes and protects the whole family skin

My essential oils

- 🔸 Cadier wood
- 🔸 Neroli
- 🔸 Roman chamomile
- 🔸 Palmarosa

My effects

- 🌿 Antiseptic, soothing, parasiticide
- 🌸 Relaxing
- 🌼 Anti-inflammatory, painkiller, soothing
- 🌺 Antibacterial, antifungal, painkiller, anti-infectious, healing



My use



- 1 Clean up and purify the face and body with the cleansing base Gimme soothing! (a few drops on the I love K konjac sponge or with the hand).
- 2 Rinse clean with water then with Eau de Genie or with a thermal/floral water in order to remove impurities.
- 3 Then apply a daily care or few drops of Gimme soothing!, Gimme clear!, Antiseche or Gimme clean! lotion.

My key tips

- Ideal to wash and protect the skin after the beach or pool, shave gently on a damaged / itchy skin.
- Can be externally used on the mucous membranes.
- It is recommended to follow the protocol until the improvement of the skin aspect.
- It is recommended to continue the protocol as a preventive measure and / or from the reappearance of the first symptoms.

GIMME SOOTHING! LOTION

My field of action

- ✓ Natural and active oil to soothe, relieve and repair sensitive, very dry and irritated skin that can be accompanied by itching, tightness, eczema and psoriasis

My oils

- 🔥 Cadier wood essential oil
- 🔥 Roman chamomile essential oil
- 🔥 Lentisque essential oil
- 🔥 Palmarosa essential oil
- 🔥 Wheat germ oil

My effects

- 🌿 Antiseptic, soothing, parasiticide
- 🌿 Anti-inflammatory, painkiller, soothing
- 🌿 Decongestant
- 🌿 Antibacterial, antifungal, painkiller, anti-infectious, healing
- 🌿 Regenerative, restorative, antioxidant

My use



- 1 Carefully clean the skin and dry it gently.
- 2 Apply few drops of the lotion on irritated areas (face, eyebrows, ears, body and scalp) and massage until complete penetration of the product.

My key tips

- For very sensitive and fragile skins, to be used in addition to the cleansing base Gimme soothing!
- Can be externally used on the mucous membranes



My precautions for use

- Not suitable for children under 10 years.
- It is recommended to use the product twice a day.
- Do not exceed 4 applications per day.

Proven effectiveness* !

Gimme soothing! lotion
100% active and natural



Atopic dermatitis is a very frequent allergic dermatitis mainly characterized by redness, scales as well as itching.

*Tests and results in 15 days on hands!

GIMME CLEAN! SHAMPOO

My field of action

- ✓ Calm and protects the peeled (dandruff) or very irritated scalp
- ✓ Relieves itching and irritation until seborrheic dermatitis
- ✓ Gently cleans and purifies the scalp

My ingredients

- 🔥 Roman chamomile essential oil
- 🔥 Coriander Leaf essential oil
- 🔥 Cedar wood essential oil
- 💧 Lavender floral water

My effects

- 🌼 Anti-inflammatory, painkiller, soothing
- 🌿 Antibacterial, fungicidal, painkiller
- 🌿 Antiseptic, soothing, parasiticide
- 🌼 Purifying, soothing



My use



- 1 Apply few drops of Gimme clean! shampoo to the entire hair and scalp and massage gently.
- 2 Rinse clean.
- 3 Make a second shampoo and let rest and act a few minutes before rinsing.

My key tips

- Cedar oil reduces dandruff.
- For best results, use the very concentrated in natural assets Gimme clean! lotion. For men, after shaving, clean the face with this shampoo.
- It is recommended to follow the protocol until the improvement of the skin aspect.
- It is recommended to continue the protocol as a preventive measure and / or from the reappearance of the first symptoms.

My precautions for use

- It is recommended to use the product to each shampoo.

GIMME CLEAN! LOTION

My field of action

- ✓ Skin and scalp natural anti-itch care
- ✓ Calm the most stubborn irritations, itching and desquamations until seborrheic dermatitis

My oils

- 🔥 Roman chamomile essential oil
- 🔥 Coriander Leaf essential oil
- 🔥 Cadier wood essential oil
- 🔥 Apricot Kernel oil

My effects

- 🌸 Anti-inflammatory, painkiller, soothing
- 🌿 Antibacterial, fungicidal, painkiller
- 🌿 Antiseptic, soothing, parasiticide
- 🍑 Revitalizing, nourishing, softening

My use



- 1 Carefully clean the face and body.
- 2 Dry without rubbing.
- 3 Apply few drops of Gimme clean! lotion on irritated areas and massage until complete penetration of the product.



My key tips

- Illuminates dull complexion.
- Once or twice a week, make a more thorough treatment: apply a few drops of lotion on the affected areas and let it take about 20 minutes before the shampoo.
- Formidable to finish with skin and nails mycoses.

My precautions for use

- It is recommended to use the product to each shampoo.

MOUSSAILLON SOAP

PROTECTED
CONCEPT

My field of action

- ✓ Softens and repairs the skin
- ✓ Suitable for sensitive, irritated, itchy and damaged skin

My ingredients

- Soap base with Olive
- Organic Shea butter
- Perfume from lemon essential oil
- Perfume from lavender essential oil

My effects

- Nourishing, softening
- Protector, nourishing, repairing
- Illuminating, toning, purifying
- Soothing, healing, regenerating, protective



My use

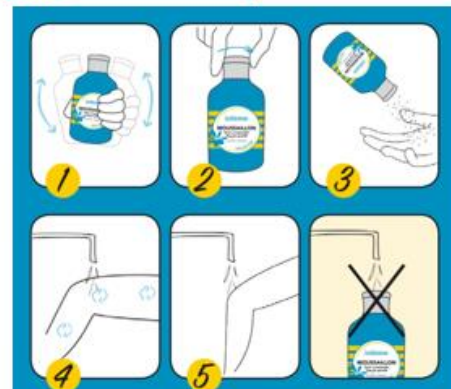

My key tips

- New experience, ultra innovative powder bottle
- 1 Moussaillon soap = 4 months of use
- Ideal for children

My precautions for use

- Close the cap immediately after use.

DOMI-NO

My field of action

- ✓ Blackheads remover to effectively get rid of even difficult access dots, hygienically and without leaving nasty traces on the skin

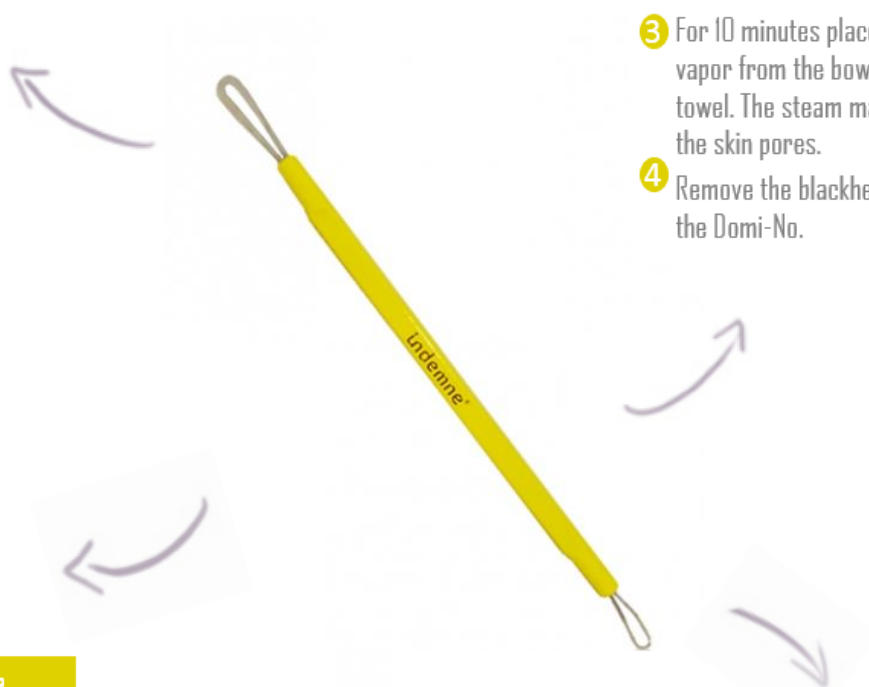

My precautions for use

- Before and after each use, it is recommended to disinfect the blackhead remover.
- Do not use Domi-No on spots.
- To press too hard can cause an infection or scars.
- Do not apply near eyes and mouth.
- This is not a toy; do not leave within the reach of the children.

My use



- 1 Apply this tool on a cleansed skin.
- 2 Make a steam bath of the face: fill a bowl with warm water and add a few drops of Tea tree essential oil.
- 3 For 10 minutes place the face over the water vapor from the bowl and cover the head with a towel. The steam makes "sauna" and will dilate the skin pores.
- 4 Remove the blackheads using one of the tips of the Domi-No.

My key tips

- We recommend to use the Domi-No blackhead remover in addition to the Gimme clear! lotion (Which will soothe, purify, and heal the skin after the accessory use.

I LOVE K

My field of action

- ✓ 100% natural and vegetal konjac sponge with violet to gently and thoroughly clean all skin even the most fragile or acneic.



My precautions for use

- Wash thoroughly before first use
- After use, rinse the sponge and press it until dry. Store and hang the sponge in a cool, well-ventilated place to air dry properly.
- This is not a toy; do not leave within the reach of the children

My use

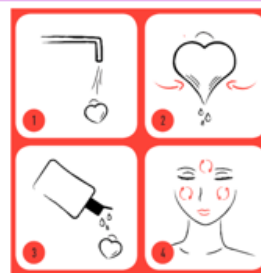

- 1 Soak the konjac sponge with water to soften it.
- 2 Press the sponge to wring it.
- 3 Add few drops of the Miss Ella lotion or the cleansing base Gimme soothing!
- 4 Gently massage the skin in circular motions.
- 5 Rinse the sponge and hang it with the cord to dry it until the next use.

My key tips

- For more efficiency replace every 2 - 3 months.

ANTI-IMPERFECTION KIT

My field of action

- ✓ The anti-imperfection kit targets the pimples up to acne, microcysts, young or advanced scars, and reduces excess sebum
- ✓ 3 steps treatment which allows to clean, to tone up the skin and to daily fight against imperfections



3 steps kit

Step 1: Miss Ella lotion 8,67 fl. oz: gently cleans and removes make-up.

Step 2: Eau de genie 4,5 fl. oz: tones and perfectes make-up removal.

Step 3: Gimme clear! lotion 1,67 fl. oz: acts in depth and durably on imperfections such as pimples, microcysts, scars.

My use



- 1 Clean and remove face and eyes with a few drops of Miss Ella lotion.
- 2 Rinse the micellar water with 2-3 sprays of Water Engineering to wipe with a cotton (It is ALWAYS necessary to rinse a micellar water).
- 3 Apply 1 to 2 drops of Gimme clear! lotion on imperfections by massaging until complete penetration of the product.

My key tips

- Cleanse and remove make-up from the skin using I Love K.
- Use Domi-No to remove blackheads in a simple, hygienic way without trace on the skin.
- The cure must be carried out morning and evening on a minimum of 56 days and renewed 2 to 3 times a year.

Non contractual photo. The colors and the shape of the box may vary according to the available stock.

ANTI-CELLULITE KIT

My field of action

- ✓ The anti-cellulite treatment targets young or encrusted cellulite, its effectiveness is proven, up to -3.4 cm!
- ✓ 3 steps treatment which allows to smooth, tone up and release deep orange-peel skin



3 steps kit

Step 1: Gimme smooth! lotion: smooths and reduces cellulite, it's proven! (Up to -3.4 cm on the hips, -1.9 cm on the thighs, -2.9 cm on the arms)!**

Step 2: Slimming cup Big bubble-in: imitates the action of palper-rouler technique against inlaid cellulite.

Step 3: Tape measure: to evaluate your progress.

**Clinical efficacy tests performed under dermatological control on a panel of 23 women over 56 days.

My use



- 1 Apply Gimme smooth! to help the Bubble to slide.
- 2 Evacuate the air from the Bubble-in by pressing it
- 3 Put it on the skin, a slight suction will "lift" the cellulite.
- 4 Vertically massage the skin from top to bottom, horizontally from left to right then with a zig-zag move doing a "Z".

My key tips

- Can also be used for back massage or after a sport session to relieve and boost the blood circulation!
- Gimme smooth! : It is recommended to follow the protocol on minimum 8 consecutive weeks (= 2 bottles) and until improvement of the skin appearance.
- It is recommended to continue the protocol as a preventive measure and / or from the reappearance of the first symptoms.

Non contractual photo. The colors and the shape of the box may vary according to the available stock.

ANTI-IRRITATION KIT

My field of action

- ✓ The anti-irritation kit is effective to treat sensitive, dry or very dry skin that stings and scratches, up to eczema and psoriasis
- ✓ Objectives: Gently clean and protect; Calm and repair

My use



- 1 Gently clean up the face or the body with the cleansing base Gimme soothing! few drops on the I love K sponge I love K are necessary to deep clean and remove impurities.
- 2 Apply few drops of Gimme soothing! Lotion in order to nourish irritated skins and relieve itching.



3 steps kit

- Step 1:** Cleansing base Gimme soothing! 8,5 fl. oz: repairing and gentle cleansing gel.
- Step 2:** Gimme soothing! lotion 1,67 fl. oz ml: Repairs, nourishes, and protects your skin.
- Step 3:** I Love K konjac sponge: for a gentle cleansing.

My key tips

- The cleansing base Gimme soothing! is ideal to wash and protect the skin after the beach or pool, shave gently on a damaged / itchy skin.
- I love K konjac sponge: for more efficiency replace every 2 - 3 months.

Non contractual photo. The colors and the shape of the box may vary according to the available stock.

My field of action

- ✓ The anti-itching kit is effective to treat le
Calm the most stubborn irritations, itching
and desquamations until seborrheic
dermatitis
- ✓ Acts on the blotchy and rosaceous faces,
revitalizes them and restores shine to the
dull faces

My use



- 1 Apply few drops of the Gimme clean! shampoo to the entire hair and scalp and massage gently.
- 2 Apply few drops of Gimme clean! lotion on irritated areas and massage until complete penetration of the product.



3 steps kit

Step 1: Gimme clean! lotion 1,67 fl. oz: soothes and treats the skin while giving a shine

Step 2: Gimme clean! shampoo 7 fl. oz: protects, purifies and relieves the skin and scalp. It also regulates sebum excess and dandruff.

Step 3: I Love K konjac sponge : for gentle cleansing.

My key tips

- Gimme clean! lotion: once or twice a week, make a more thorough treatment: apply a few drops of lotion on the affected areas and let it take about 20 minutes before the shampoo.
Formidable to finish with skin and nails mycoses
- Gimme clean! shampoo: for men, after shaving, clean the face with the shampoo.
- I love K konjac sponge: for more efficiency replace every 2 - 3 months.

Non contractual photo. The colors and the shape of the box may vary according to the available stock.

General precautions for use

	Always test the product on your inner elbow and leave for 24 hours before applying to larger skin areas.	From 36 months.	Do not use the product on damaged skin.	Before and after use, wash your hands thoroughly. Wash hands thoroughly before and after use.	Apply the product on clean skin.	Do not rinse.	Avoid sun exposure immediately after application.	Tightly closing the bottle after use to prevent active plant extracts to fly away!	Avoid contact with eyes. If contact, rinse with clear water.
Gimme clear!	✓	✓	✓	✓	✓	✓	✓	✓	✓
Antiseche	✓	✓	✓	✓	✓	✓	✓	✓	✓
Miss Ella	✓	✓	✓	✓	✓			✓	✓
Eau de genie	✓	✓	✓	✓	✓			✓	✓
Gimme smooth!	✓	✓	✓	✓	✓	✓	✓	✓	✓
Gimme soothing! cleansing base	✓	✓	✓					✓	✓
Gimme soothing! lotion	✓	✓	✓	✓	✓	✓	✓	✓	✓
Gimme clean! shampoo	✓	✓	✓					✓	✓
Gimme clean! lotion	✓	✓	✓	✓	✓	✓		✓	✓
Moussaillon soap	✓	✓	✓					✓	✓
Bubble-in/ Big Bubble-in			✓		✓				
Domi-no			✓	✓	✓				
I love K			✓	✓	✓				



See our advice on
www.indemne.uk



31/07/ 2017

